



# HF-Performer II (flat) for TL5 lamps

HF-Performer 3/414 TL5 EII 220-240V 50/60Hz

Flat, slim, lightweight High Frequency electronic ballast for TL5 fluorescent lamps, based on EII technology

## Product data

### • General Characteristics

Application code	EII
Rated Lamptype	TL5
Rated Number of Lamps	3/4 piece
Rated Ballast-Lamp Power	14
Line Voltage	220-240 V
Line Frequency	50/60 Hz
Housing	L 360x30x21
Energy Efficiency Index	A2
Lifetime 90% surv.@Tcaselife	50000 hr
Ignition Method	Warm Start

### • Operating Characteristics

Automatic restart	Yes
Ignition time	0.4 (max) s
Operating frequency	27 (nom), 28 (max) kHz
Mains voltage safety (AC)	-10%/+10%
Mains voltage performance (AC)	-8%/+6%
Inrush current Peak	24 (max) A
Inrush current Width	0.25 ms
Earth leakage current	0.5 mA
Power losses gear	5.0/6.0 W
Constant wattage deviation	-2%/+2%
Ballast Lumen Factor	1.0 -
PowerFactor 100%	0.96 -
output power	
Battery voltage lamp ignition	198-254 V

Battery voltage running lamps	176-254
Overvoltage protection 320Vac	48 hr
Overvoltage protection 350Vac	2 hr
Max ballast on MCB(16A type B)	28 x
Crestfactor	1.7 (max) -
Hum and Noise level	Inaudible
Total Harmonic Distortion EUR	15 %

### • Wiring Characteristics

Cable-Cap output-wires to earth	200 pF
Cable-Cap output-wires mutual	200 pF
Conn.type input terminals	WAGO 251 universal connector [Suitable for both automatic wiring (ALF and ADS) and manual wiring]
Conn.type output terminals	WAGO 251 universal connector [Suitable for both automatic wiring (ALF and ADS) and manual wiring]
Max. cable length Device/Lamp	2.0 m
Max. cable length Hot Wires	0.5 m
Striplength	8.0-9.0 mm
Dual fixture Master/Slave	No [Master/Slave operation not possible]
Wcs Input terminals	0.50-1.00 mm <sup>2</sup>
Wcs Output terminals	0.50-1.00 mm <sup>2</sup>
Wcs auto insertion (ALF/ADS)	0.5 mm <sup>2</sup>



# HF-Performer II (flat) for TL5 lamps

## • System Chars on driver level

Rated Lamp Power on TL5	14
System Power on TL5	18.7/19.7/27.7
Lamp Power on TL5	13.7/13.7/20.7
Power Loss on TL5	5/6/7

## • Temperature Characteristics

T-case life	75 C
T-case maximum	75 (max) C
T-ignition	-25 (min), 50 (max) C
T-ambient	-25 (min), 50 (max) C
T-storage	-40 (min), 80 (max) C

## • Product Dimensions

Length A1	360.0 mm
Fixing Hole Distance	350.0 mm
Length A2	
Width B1	30.0 mm
Height C1	22.0 mm
Fixing Hole Diameter D1	4.2 mm

## • Approval & Application Chars

EMI 9kHz .. 30 MHz	EN 55015
EMI 30 MHz .. 1000MHz	EN 55022 level A [Level = Class]
Safety Standard	IEC 61347-2-3
Performance Standard	IEC 60929

Quality Standard	ISO 9000:2000
Environmental Standard	ISO 14001
Harmonic current emissions	IEC 61000-3-2
EMC Immunity	IEC 61547
Vibrations	IEC 68-2-6 Fc
Bumps	IEC 68-2-29 Eb
Humidity	EN 61347-2-3 clause 11
Approval marks	ENEC / VDE-EMV
CE marking	Yes
Temperature marking	110 [Yes]
Emergency standard	IEC 60598-2-22

## • Product Data

Order code	913700601366
Full product code	913700601366
Full product name	HF-P 3/414 TL5 EII 220-240V 50/60Hz
Order product name	HF-P 3/414 TL5 EII 220-240V 50/60Hz
Pieces per pack	1
Packing configuration	12
Packs per outerbox	12
Bar code on pack - EAN1	8711500059840
Bar code on outerbox - EAN3	8711500059857
Logistic code(s) - 12NC	913700601366
Net weight per piece	0.259 kg

## Dimensional drawing

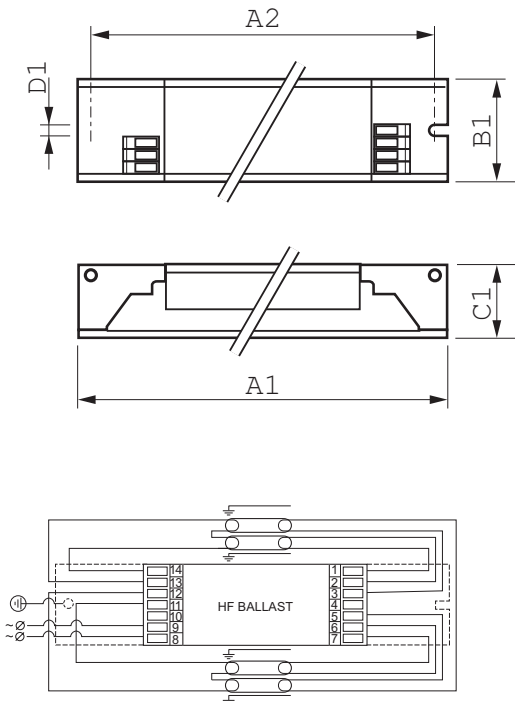

## HF-Performer 3/414 TL5 EII 220-240V 50/60Hz

Product	A1 (Norm)	A2 (Norm)	B1 (Norm)	C1 (Norm)	D1 (Norm)
HF-P 3/414 TL5 EII 220-240V 50/60Hz	360.0	350.0	30.0	22.0	4.2



© 2014 Koninklijke Philips N.V. (Royal Philips)  
All rights reserved.

Specifications are subject to change without notice. Trademarks are the property of Koninklijke Philips N.V. (Royal Philips) or their respective owners.

[www.philips.com/lighting](http://www.philips.com/lighting)

2014, April 11  
data subject to change